

20/02243/FUL - Straight Path Paddock, Pricketts Hill,
Shedfield, Hampshire.

Variation of condition 2 & 4 to add an additional 3
mobile homes (18/01264/FUL)







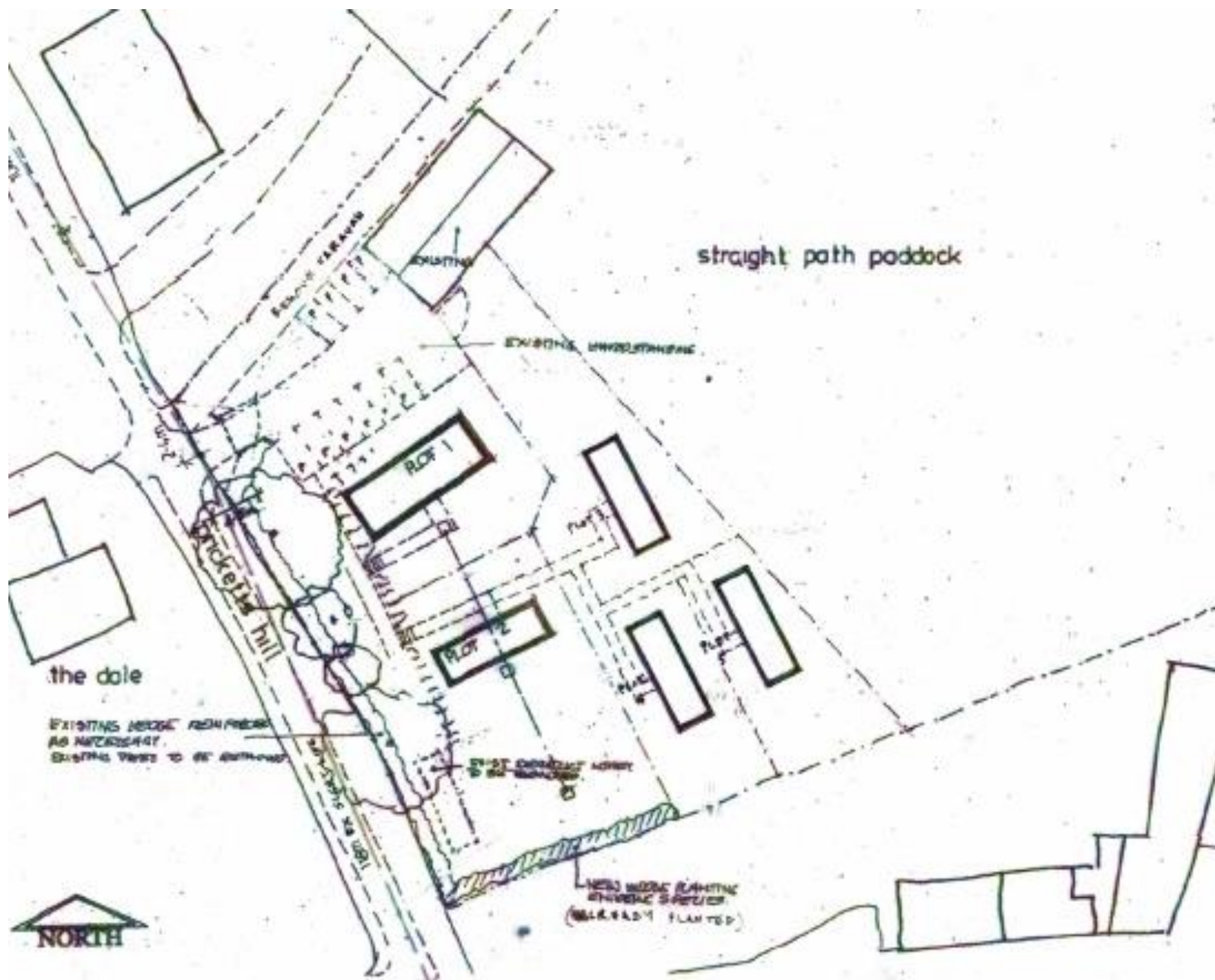



Parking area looking toward
Pricketts Hill and the access



Looking west within the
plot to the boundary with
Pricketts Hill.



Looking north



Looking toward the agricultural part of the site secured via a post and rail fence.



Looking south east. Planting required under previous application has been implemented along southern boundary.



Looking south west over one of the existing amenity areas



Looking south over are proposed for 3 additional pitches. Track to be removed and replaced with foot path.

Recommendation Permit

The proposal accords with Development Plan policies.